PRESENTATION

Contents

KEY TO SYMBOLS

Key to symbols	66
Explanation of warning levels	66

PRESENTATION

Contents	67
Dear Customer,	67

PRESENTATION

What is what on the lawn mower?	68
---------------------------------------	----

MACHINE'S SAFETY EQUIPMENT

General	69
---------------	----

ASSEMBLING AND ADJUSTMENTS

General	70
Handlebar	70
Cutting height	71
Catcher	72
Mulcher insert	72
Rear discharging	72

FUEL HANDLING

General	73
Fuel	73
Fueling	73
Transport and storage	73

OPERATING

Personal protective equipment	74
General safety precautions	74
Basic working techniques	75
Transport and storage	75
Starting and stopping	76

MAINTENANCE

General	77
Maintenance schedule	77
General inspection	77
Spark plug	79
Adjusting the drive belt	79
Air filter	79
Oil change	79
Fuel system	79

TECHNICAL DATA

Technical data	80
EC Declaration of Conformity	81

Dear Customer,

Congratulations on your choice to buy a Husqvarna product! Husqvarna is based on a tradition that dates back to 1689, when the Swedish King Karl XI ordered the construction of a factory on the banks of the Husqvarna River, for production of muskets. The location was logical, since water power was harnessed from the Huskvarna River to create the water-powered plant. During the more than 300 years in existence, the Husqvarna factory has produced a lot of different products, from wood stoves to modern kitchen appliances, sewing machines, bicycles, motorcycles etc. In 1956, the first motor driven lawn mowers appeared, followed by chain saws in 1959, and it is within this area Husqvarna is working today.

Today Husqvarna is one of the leading manufacturers in the world of forest and garden products, with quality as our highest priority. The business concept is to develop, manufacture and market motor-driven products for forestry and gardening, as well as for the building and construction industry. Husqvarna's aim is also to be at the front edge for ergonomics, usability, security and environmental protection. That is the reason why we have developed many different features to add to our products within these areas.

We are convinced that you will appreciate with great satisfaction the quality and performance of our product for a very long time to come. The purchase of one of our products gives you access to professional help with repairs and service whenever this may be necessary. If the retailer who sells your machine is not one of our authorised dealers, ask for the address of your nearest service workshop.

It is our wish that you will be satisfied with your product and that it will be your companion for a long time. Think of this operator's manual as a valuable document. By following its content (usage, service, maintenance, etc), the life span and the second-hand value of the machine can be extended. If you sell this machine, make sure that the operator's manual is passed on to the buyer.

Thank you for using a Husqvarna product.

Husqvarna AB has a policy of continuous product development and therefore reserves the right to modify the design and appearance of products without prior notice.

PRESENTATION

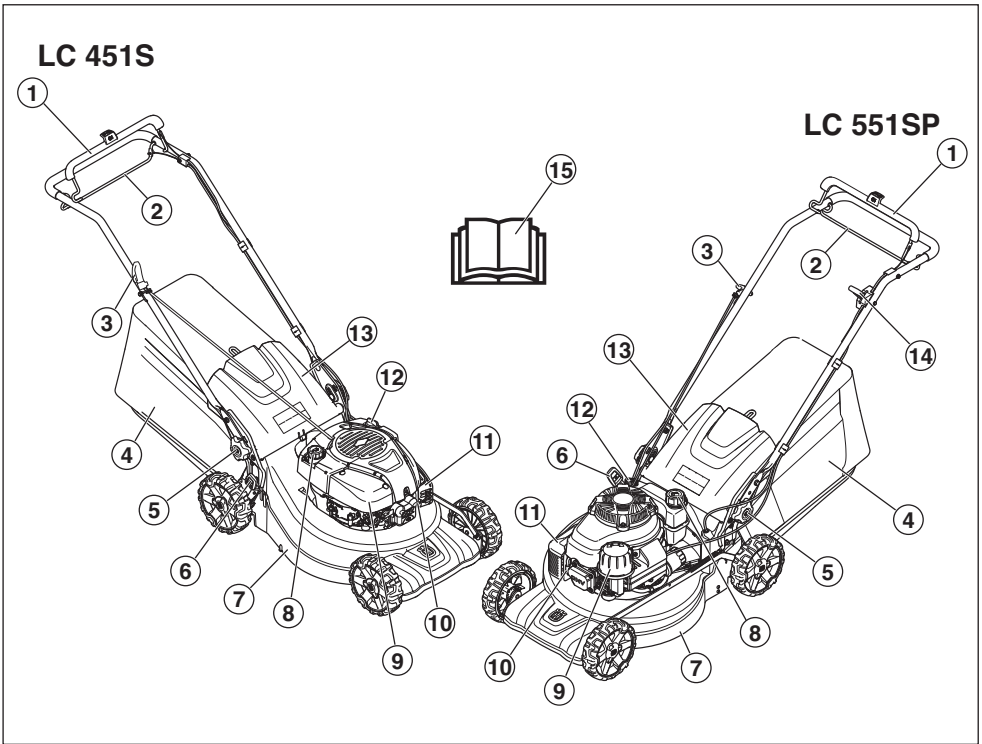

What is what on the lawn mower?

- | | |
|--|--------------------------------|
| 1 Engine brake handle | 9 Air filter |
| 2 Propulsion bar | 10 Spark plug |
| 3 Starter handle | 11 Muffler |
| 4 Catcher | 12 Dipstick/oil filler |
| 5 Locking lever for handle height adjustment | 13 Back shield |
| 6 Cutting height control | 14 Throttle trigger (LC 551SP) |
| 7 Cutting cover | 15 Operator's manual |
| 8 Refuelling | |

MACHINE'S SAFETY EQUIPMENT

General

This section describes the machine's safety equipment, its purpose, and how checks and maintenance should be carried out to ensure that it operates correctly.



WARNING! Never use a machine that has faulty safety equipment! If your machine fails any checks contact your service agent to get it repaired.

Do not modify this product or use it if it appears to have been modified by others. Prevent unintentional starting by removing the ignition cable from the spark plug.

Cutting cover

- The cutting cover is designed to reduce vibration and to reduce the risk of cuts.

Checking the cutting cover

- Make sure the cutting cover is not damaged and that there are no visible defects such as cracks in the protective outer cutting cover.

Engine brake handle

- The engine brake is designed to stop the engine. When the grip on the engine brake handle is released the engine should stop.

Inspecting the engine brake handle

Start the machine according to the starting instructions, see "Starting and Stopping", and then release the brake handle. The engine brake should always be adjusted so that the engine stops within 3 seconds.

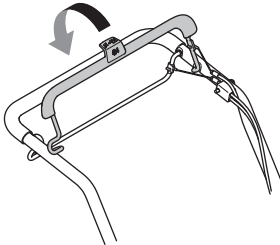

Muffler



WARNING! Never use a machine without a muffler, or with a faulty muffler. A damaged muffler may substantially increase the noise level and the fire hazard. Keep fire fighting equipment handy.

The muffler gets very hot during and after use. This also applies during idling. Be aware of the fire hazard, especially when working near flammable substances and/or vapours.

- The muffler is designed to keep noise levels to a minimum and to direct exhaust fumes away from the user.

Inspecting the muffler

- Check regularly that the muffler is complete and secured correctly.

ASSEMBLING AND ADJUSTMENTS

General



IMPORTANT! Prevent unintentional starting by removing the ignition cable from the spark plug.

Handlebar

Assembly

- 1 Loosen the lower knobs on both sides of the machine. Check that the plastic washer is correctly in place in the recess in the handle attachment.

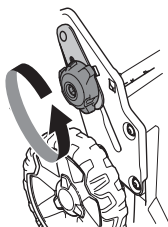

- 2 Fit the handlebar folded forward with the plastic washer placed between it and the handle attachment.

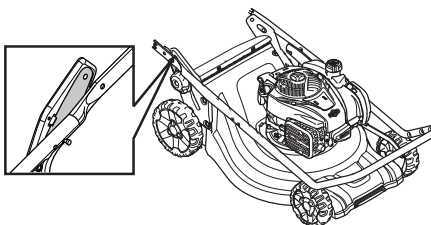

CAUTION! Check that cables and wires run along the inside of the handlebar and are not twisted around each other.

- 3 Fasten the handlebar to the handle attachment with screw, washer and bolt.

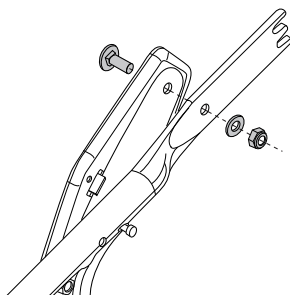

- 4 Unfold the handlebar and fasten the knob on both sides of the machine. Adjust to a suitable height. For more information, see "Adjustment".

- 5 Place the wires in the cable bracket. Make sure the wires are not twisted around each other. Fasten the cable bracket underneath the handlebar.

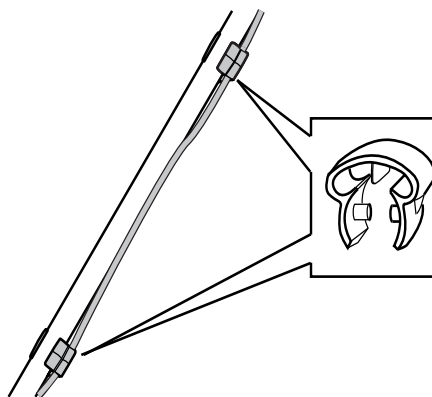

- 6 Run the wires along the underside of the handlebar. Insert the wires into the second cable bracket, which is then fastened to the upper part of the handlebar.
- 7 Fix the cables to the handle support by using a cable tie.

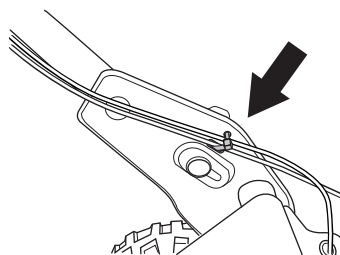

ASSEMBLING AND ADJUSTMENTS

Settings

Handle height

- Loosen the lower knobs.
- Slide the knobs to the ends of the grooves on both sides of the machine.

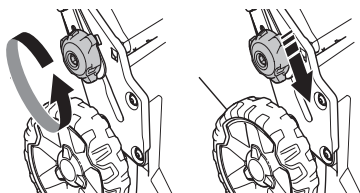

- Handle height can be set to 2 different positions.
- Adjust to a suitable height.
- Slide the knobs up towards the handle until they stop and a click is heard. Tighten the knobs properly.

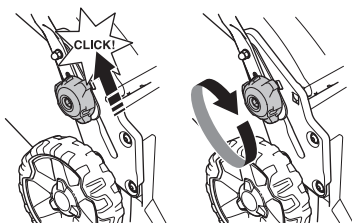

Transport position

The handle assembly can be folded to minimize space needed for transport and storage.

- Loosen the lower knobs.
- Slide the knobs to the ends of the grooves on both sides of the machine.

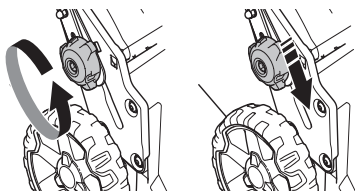

- Fold forward the handle.

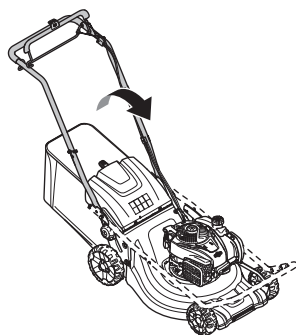

Operating position

- Fold the handle to its upright position.

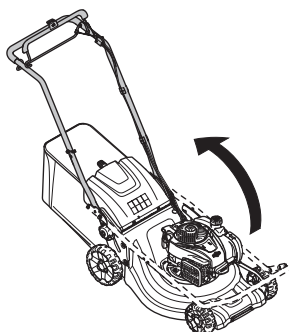

- Slide the knobs up towards the handle until they stop and a click is heard.

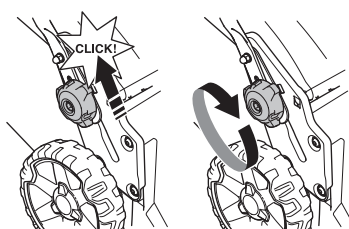

- Screw on the handle with the knob.

Cutting height

NOTICE! Do not set the cutting height too low as there is a risk that the cutters might hit ground with unevenness.

The machine is equipped with central cutting height adjustment.

- To adjust the cutting height, press the height adjuster towards the wheel and then move it forwards to give a lower cutting height and backwards to give a higher cutting height.

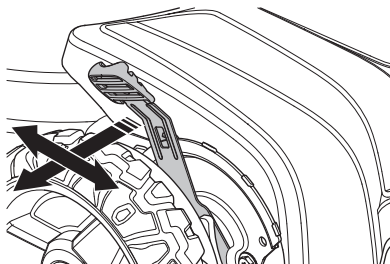

- The cutting height can be adjusted in 6 different steps.

ASSEMBLING AND ADJUSTMENTS

Catcher

- The collector's handle situated on the frame must be placed over the collector bag.

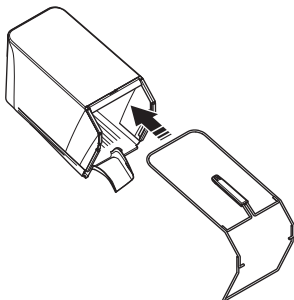

- Fasten the lower part of the frame in the groove underneath the collector.
- Secure the frame by using the quick-action clips.

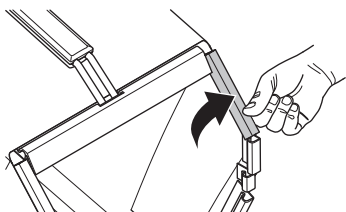

- Make sure the machine's discharge deck is clean and free from grass cuttings.
- Hook the collector onto the top edge of the chassis.
- Place the collector tongue in the machine's discharge deck.

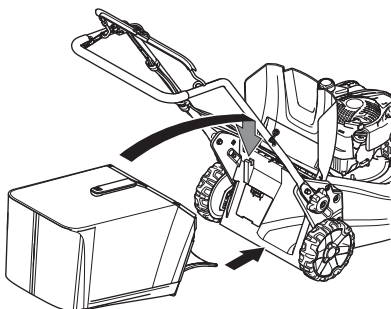

- Fit the bagger bottom in the discharge hole.

Mulcher insert - Accessories

A mulching-kit is available as an accessory, to make the machines equipped with a catcher able to be used with mulching function. The kit contains of a mulch plug and a blade.

- Raise the discharge guard to mount / dismount the mulch plug.

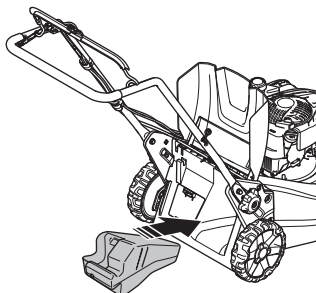

- Replace the blade with the supplied Combi blade. For more information, see "Cutting equipment".

Rear discharging

The machine can also be used without the mulcher insert and collector.

- Lift up the back shield and remove the catcher.
- Remove the mulch plug.
- Close the shield.

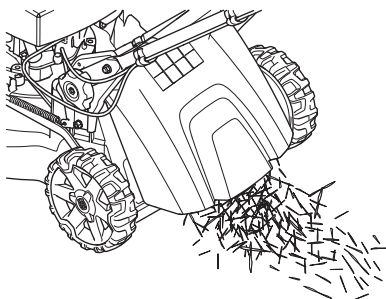

FUEL HANDLING

General



WARNING! Running an engine in a confined or badly ventilated area can result in death due to asphyxiation or carbon monoxide poisoning.

Fuel and fuel fumes are highly inflammable and can cause serious injury when inhaled or allowed to come in contact with the skin. For this reason observe caution when handling fuel and make sure there is adequate ventilation.

The exhaust fumes from the engine are hot and may contain sparks which can start a fire. Never start the machine indoors or near combustible material!

Do not smoke and do not place any hot objects in the vicinity of fuel.

Fuel

NOTICE! The machine is equipped with a four-stroke engine. Make sure that there is always sufficient oil in the oil tank.

Petrol

- Use good quality unleaded or leaded petrol.
- The lowest octane recommended is 90 (RON). If you run the engine on a lower octane grade than 90 so-called knocking can occur. This gives rise to a high engine temperature, which can result in serious engine damage.
- Use low-emission petrol, also known as alkylate petrol, if it is available.

Engine oil

NOTICE! Check the oil level before starting the lawn mower. A too low oil level can cause serious damage to the engine. See instructions in the section "Maintenance".

- The engine oil should be changed the first time after 5 hours running time. Refer to Technical Data for recommendations on which oil type to use. Never use oil intended for two-stroke engines.

Fueling



WARNING! Always stop the engine and let it cool for a few minutes before refuelling.

Use a petrol can at all times to avoid spillage.

Clean the area around the fuel cap.

When refuelling, open the fuel cap slowly so that any excess pressure is released gently.

Tighten the fuel cap carefully after refuelling. Negligence may lead to the start of a fire.

Move the machine at least 3 m from the refuelling point before starting it.

Never start the machine:

- If you have spilled fuel or engine oil on the machine. Wipe off the spill and allow the remaining fuel to evaporate.
- If you have spilled fuel on yourself or your clothes, change your clothes. Wash any part of your body that has come in contact with fuel. Use soap and water.
- If the machine is leaking fuel. Check regularly for leaks from the fuel cap and fuel lines.

Transport and storage

- Store and transport the machine and fuel so that there is no risk of any leakage or fumes coming into contact with sparks or open flames, for example, from electrical machinery, electric motors, electrical relays/ switches or boilers.
- When storing and transporting fuel always use approved containers intended for this purpose.

Long-term storage

- When storing the machine for long periods the fuel tank must be emptied. Contact your local petrol station to find out where to dispose of excess fuel.

OPERATING

Personal protective equipment

You must use approved personal protective equipment whenever you use the machine. Personal protective equipment cannot eliminate the risk of injury but it will reduce the degree of injury if an accident does happen. Ask your dealer for help in choosing the right equipment.

Always wear:

- Use ear muffs if the noise level exceeds 85 db.
- Sturdy, non-slip boots or shoes.
- Heavy, long pants. Do not wear shorts, sandals or go barefoot.
- Gloves must be worn when required, for example when fitting, inspecting or cleaning cutting attachments.

General safety precautions

This section describes basic safety directions for using the machine. This information is never a substitute for professional skills and experience.

- Please read the operator's manual carefully and make sure you understand the instructions before using the machine.
- Keep in mind that the operator is responsible for accidents or hazards occurring to other people or their property.
- The machine must be kept clean. Signs and stickers must be fully legible.

Always use common sense

It is not possible to cover every conceivable situation you can face. Always exercise care and use your common sense. If you get into a situation where you feel unsafe, stop and seek expert advice. Contact your dealer, service agent or an experienced user. Do not attempt any task that you feel unsure of!



WARNING! This machine produces an electromagnetic field during operation. This field may under some circumstances interfere with active or passive medical implants. To reduce the risk of serious or fatal injury, we recommend persons with medical implants to consult their physician and the medical implant manufacturer before operating this machine.



WARNING! The machine can be a dangerous tool if used incorrectly or carelessly, which can cause serious or fatal injury to the operator or others.

Never allow children or other persons not trained in the use of the machine to use or service it.

The machine should not be used by people with reduced physical or mental capacities or people who are unsuitable for health reasons to operate the machine, without supervision of a person responsible for their safety.

Never allow anyone else to use the machine without first ensuring that they have read and understood the contents of the operator's manual.

Never use the machine if you are fatigued, while under the influence of alcohol or drugs, medication or anything that could affect your vision, alertness, coordination or judgement.



WARNING! Unauthorized modifications and/or accessories may lead to serious injury or death to the user or others. Under no circumstances may the design of the machine be modified without the permission of the manufacturer.

Do not modify this product or use it if it appears to have been modified by others.

Never use a machine that is faulty. Carry out the checks, maintenance and service instructions described in this manual. Some maintenance and service measures must be carried out by trained and qualified specialists.

Always use genuine accessories.

OPERATING

Work area safety

- Branches, twigs, stones, etc. should be removed from the lawn before you start to mow.
- Objects hitting against the cutting attachment could be thrown and cause damage to people and objects. Keep people and animals well away.
- Never use the machine in bad weather, for instance in fog, in rain, damp or in wet locations, strong winds, intense cold, risk of lightning, etc. Working in bad weather is tiring and can lead to dangerous conditions, e.g. slippery surfaces.
- Observe your surroundings to ensure that nothing can affect your control of the machine.
- Beware of roots, stones, twigs, pits, ditches etc. Tall grass can hide obstacles.
- Mowing slopes can be dangerous. Do not use the lawn mower on very steep slopes. The lawn mower should not be used on inclines greater than 15 degrees.
- On sloping ground you should work along the slope. It is much easier to work along a slope than it is to work up and down it.
- Be careful when you are approaching hidden corners and objects that could block your view.

Work safety

- A lawn mower is only designed to mow lawns. All other use is forbidden.
- Wear personal protective equipment. See instructions under the "Personal protective equipment" heading.
- Do not start a lawn mower unless the cutter and all covers are fitted correctly. Otherwise the cutter could come loose and cause personal injuries.
- Make sure the cutter does not hit foreign objects such as stones, roots or the like. This can make the cutter dull and bend the engine shaft. A bent axle gives imbalance and heavy vibration, which results in a great risk of the cutter becoming loose.
- The brake handle must never be permanently anchored in handle when the machine is running.
- Place the lawn mower on firm, flat surface and start it. Make sure that the cutter cannot come into contact with the ground or other objects.
- Always place yourself behind the machine. Allow all the wheels to remain on the ground and keep both hands on the handle when mowing. Keep your hands and feet away from the rotating blades.
- Do not tilt the machine when the engine is running.
- Pay particular attention when pulling the machine towards you during work.
- Never lift up the lawn mower or carry it around when the engine is running. If you must lift the lawn mower, first switch off the engine and disconnect the ignition lead from the spark plug.

- Do not mow the lawn while walking backwards.
- The engine should be switched off when moving over ground that is not to be mowed. For example, gravel paths, stone, shingle, asphalt, etc.
- Never run with the machine when it is running. You should always walk with the lawn mower.
- Shut down the engine before changing the cutting height. Never make adjustments with the engine running.
- Never leave the machine unsupervised with the motor running. Turn off the motor. Ensure the cutting attachment has stopped rotating.
- If any foreign object is hit or if vibrations occur stop the machine immediately. Disconnect the HT lead from the spark plug. Check that the machine is not damaged. Repair any damage.

Basic working techniques

- Always cut with a sharp blade for optimal results. A dull blade gives an uneven cut and the grass becomes yellow on the surface of the cut.
- Never mow more than 1/3 of the length of the grass. This especially applies during dry periods. Mow first with the cutting height set high. Then check the result and lower to an appropriate height. If the grass is really long, drive slowly and mow twice if necessary.
- Cut in different directions each time in order to avoid stripes in the lawn.

Transport and storage

- Secure the equipment during transportation in order to avoid transport damage and accidents.
- Store the equipment in a lockable area so that it is out of reach of children and unauthorized persons.
- Store the machine and its equipment in a dry and frost proof place.
- For transport and storage of fuel, see the section "Fuel handling".

OPERATING

Starting and stopping

Before starting



WARNING! Please read the operator's manual carefully and make sure you understand the instructions before using the machine.

Wear personal protective equipment. See instructions under the "Personal protective equipment" heading.

- Keep people and animals well away from the working area.
- Perform daily maintenance. See instructions in the section "Maintenance".
- Ensure the ignition lead sits correctly on the spark plug.

Starting

LC 451S

- The engine brake handle must be held against the handlebar when the engine is started.

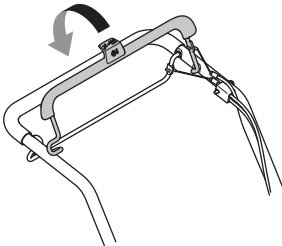

- Position yourself behind the machine.
- Grip the starter handle, slowly pull out the cord with your right hand until you feel some resistance (the starter pawls grip). Pull with force to start the engine. Never twist the starter cord around your hand.

LC 551SP

With a cold engine:

- Set the throttle control in the choke position. The throttle control regulates the engine speed, and thereby also the rotation speed of the blades.

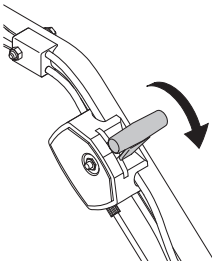

- The engine brake handle must be held against the handlebar when the engine is started.

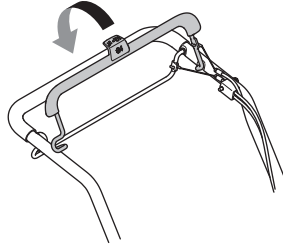

- Position yourself behind the machine.
- Grip the starter handle, slowly pull out the cord with your right hand until you feel some resistance (the starter pawls grip). Pull with force to start the engine. Never twist the starter cord around your hand.
- Set the throttle control to full throttle.

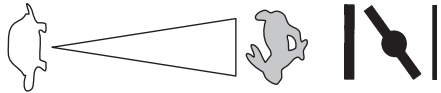

With a warm engine:

- Use the same starting procedure as for a cold engine but without setting the choke control in the choke position.

Drive

- Push the propulsion bar in towards the handle in order to start the drive.

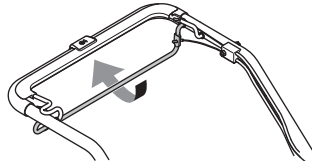

- To only stop the drive with the engine running, release only the propulsion bar.

Stopping

- Stop the engine by releasing the engine brake handle.

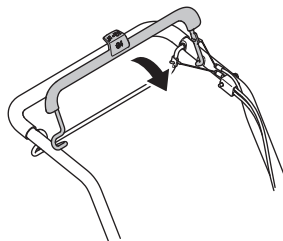

MAINTENANCE

General



WARNING! The user must only carry out the maintenance and service work described in this Operator's Manual. More extensive work must be carried out by a service workshop.

Switch off the engine before carrying out any checks or maintenance. Prevent unintentional starting by removing the ignition cable from the spark plug.

The life span of the machine can be reduced and the risk of accidents can increase if machine maintenance is not carried out correctly and if service and/or repairs are not carried out professionally. If you need further information please contact your nearest service workshop.

CAUTION! When the machine is tilted, make sure the air filter always is placed in the highest position.

- Always use genuine accessories.

Maintenance schedule

In the maintenance schedule you can see which parts of your machine that require maintenance, and with which intervals it should take place. The intervals are calculated based on daily use of the machine, and may differ depending on the rate of usage.

Before starting	Weekly maintenance	Monthly maintenance	Yearly
General inspection	Spark plug	Air filter	Cleaning under the belt guard**
External cleaning	Muffler*	Fuel system	Cleaning under the wheel plates**
Oil level			Adjustment of the gearbox stop**
Cutting equipment			
Cutting cover*			
Inspecting and adjusting the drive belt			
Engine brake handle*			

*See instructions in the section "Machine's safety equipment".

** Conducted by authorised service workshop.

Please see the engine Operator's Manual for additional information about servicing the engine.

General inspection

- Check that nuts and screws are tight.

External cleaning

- Brush leaves, grass and the like off of the lawn mower.
- Do not use a high pressure washer to clean the machine.
- Never flush water directly on the engine.
- Clean the air intake on the starter. Check the starter and starter cord.
- When cleaning under the cutting deck, turn the machine with the spark plug upwards. Empty the fuel tank.

Oil level

IMPORTANT! Allow the machine to cool. Hot oil can cause severe burn injuries.

The lawn mower should stand on flat ground when you check the oil level. Check the oil level with the dipstick on the oil filler cap.

- Remove the oil cap and wipe the dipstick clean.
- Put the dipstick back in.
- If the oil level is low, fill using engine oil up to the upper level on the dipstick.

MAINTENANCE

Cutting equipment



WARNING! Always wear heavy-duty gloves when servicing and maintaining the cutting equipment. The cutters are very sharp and cuts can occur very easily.

- Check the cutting attachment for damage or cracks. A damaged cutting attachment should always be replaced.
- Always ensure the cutter is well ground and balanced correctly.

CAUTION! The blades should be balanced after sharpening. Balancing, replacing or sharpening the blades should be conducted by a service workshop.

Damaged blades should be replaced when hitting obstacles that result in a breakdown. Let the service centre assess whether the blade can be sharpened or must be replaced.

Dismantling



WARNING! Prevent unintentional starting by removing the ignition cable from the spark plug.

- Lock the blade with a wooden block. Loosen the blade bolt and remove the blade bolt, the washer and the blade. Remove the blade bolt by turn the bolt counter-clockwise.

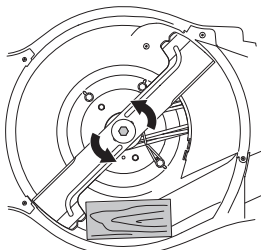

- Make sure the blade bracket is free of damage. Also check that the cutter bolt is undamaged and that the engine shaft is not bent.

Assembly

- The blade must be mounted with the angled ends pointing up towards the cover.

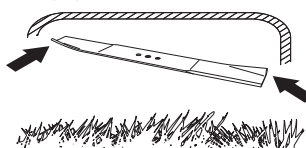

- Place the cutter with the friction washer against the cutter bracket. Make sure the cutter centres correctly on the shaft.

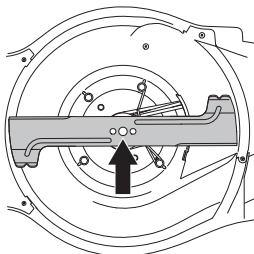

- Lock the blade with a wooden block. Fit the washer and tighten the bolt correctly by turning clockwise. The bolt should be tightened with a torque of 70 Nm.

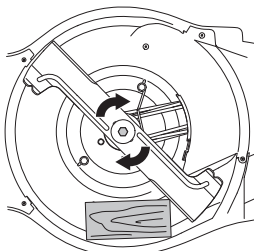

- Pull the blade around by hand and make sure it rotates freely.
- Test run the machine.

IMPORTANT!

Always exercise care and use your common sense. Avoid all situations which you consider to be beyond your capability. If you still feel uncertain about operating procedures after reading these instructions, you should consult an expert before continuing. Contact an authorised service workshop.

Always use genuine parts. For more information, see the "Technical data" section.

MAINTENANCE

Spark plug

NOTICE! Always use the recommended spark plug type! Use of the wrong spark plug can damage the piston/cylinder.

- If the machine is low on power, difficult to start or runs poorly at idle speed: always check the spark plug first before taking other steps.
- If the spark plug is dirty, clean it and check that the electrode gap is 0.5 or 0.7-0.8 mm. For more information, see the "Technical data" section. Replace the spark plug if necessary.

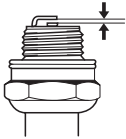

Adjusting the drive belt

If the drive feels slow, it may be due to a worn belt. The belt must in this case be replaced. Contact an authorised service workshop.

Air filter

- Remove the air filter cover and take out the filter.
- An air filter that has been in use for a long time cannot be cleaned completely. The filter must therefore be replaced with a new one at regular intervals. **A damaged air filter must always be replaced.**
- When reassembling, make sure that the filter completely seals against the filter holder.

Clean the paper filter

- Clean the filter by knocking the filter against a flat surface. Never use solvent with petroleum, for example, kerosene, or compressed air to clean the filter.

Oil change

IMPORTANT! Allow the machine to cool. Hot oil can cause severe burn injuries.

- Empty the fuel tank.
- The machine has an oil drain plug.
- Place a pan under the drain and remove the plug.
- Please see the engine Operator's Manual for more information.
- Ask where you can dispose of surplus engine oil at your local petrol station.
- Fill with new engine oil of the right quality. See instructions in the section "Technical data".

Fuel system

- Check that the fuel cap and its seal are not damaged.
- Check the fuel hose. Replace if necessary.

TECHNICAL DATA

Technical data

	LC 451S	LC 551SP
Engine		
Engine manufacturer	Briggs & Stratton	Kawasaki
Cylinder displacement, cm ³	140	161
Speed, rpm	2900	2800
Nominal engine output, kW (see note 1)	2,6	2,9
Ignition system		
Spark plug	Champion QC12YC	NGK BPR5ES
Electrode gap, mm	0,5	0,7 - 0,8
Fuel and lubrication system		
Fuel tank capacity, litre	1	1,9
*Engine oil	SAE 30/SAE 10W-30	SAE 30/SAE 10W-30
Oil tank capacity, litre	0,55	0,65
Weight		
Machine with empty tank, kg	41	51
Noise emissions (see note 2)		
Sound power level, measured dB (A)	97	97
Sound power level, guaranteed L _{WA} dB (A)	98	98
Sound levels (see note 3)		
Sound pressure level at the operators ear, dB(A)	87	87
Vibration levels, a_{hveq} (see note 4)		
Handle, m/s ²	4,1	4,5
Cutting system		
Cutting height, mm	26-74	26-74
Cutting width, cm	51	51
Cutter	Collect	Collect
Article number	5875908-10	5875908-10
Bagger capacity, litre	65	65

Note 1: The power rating of the engine indicated is the average net output (at specified rpm) of a typical production engine for the engine model measured to SAE standard J1349/ISO1585. Mass production engines may differ from this value. Actual power output for the engine installed on the final machine will depend on the operating speed, environmental conditions and other values.

Note 2: Noise emissions in the environment measured as sound power (L_{WA}) in conformity with EC directive 2000/14/EC.

Note 3: Noise pressure level according to ISO 5395. Reported data for noise pressure level has a typical statistical dispersion (standard deviation) of 1.2 dB(A).

Note 4: Vibration level according to ISO 5395. Reported data for vibration level has a typical statistical dispersion (standard deviation) of 0.2 m/s².

*Use engine oil of quality SF, SG, SH, SJ or higher. See the viscosity chart in the engine manufacturer's manual and select the best viscosity based on the expected outside temperature.

TECHNICAL DATA

EC Declaration of Conformity

(Applies to Europe only)

Husqvarna AB, SE-561 82 Huskvarna, Sweden, tel.: +46-36-146500, hereby declares that the lawn mower **Husqvarna LC 451S, LC 551SP**, starting with serial number 15XXXXXXX and onwards, complies with the requirements of the COUNCIL'S DIRECTIVE:

- of May 17, 2006 "relating to machinery" **2006/42/EC**.
- of February 26, 2014 "relating to electromagnetic compatibility" **2014/30/EU**.
- of May 8, 2000 "relating to the noise emissions in the environment" **2000/14/EC**.

For information relating to noise emissions, see the Technical data chapter.

The following standards have been applied: ISO 5395, ISO 14982

Notified body: **0404, SMP Svensk Maskinprovning AB**, Box 7035, SE-750 07 Uppsala, has issued reports regarding the assessment of conformity according to annex VI of the COUNCIL'S DIRECTIVE of May 8, 2000 "relating to the noise emissions in the environment" 2000/14/EC.

Huskvarna 25 November 2015



Claes Losdal, Development Manager/Garden Products

(Authorized representative for Husqvarna AB and responsible for technical documentation.)